

A construction worker wearing a white hard hat, a dark jacket, and a safety harness is walking on a corrugated metal roof. A lanyard is attached to the harness and secured to a metal vent on the roof. The background shows a city skyline under a clear sky.

Fall Protection Visualizer

User Guide

Part of the SFS ConnectSuite®



Introduction

Welcome to our SFS Fall Protection Visualizer tool.

This tool is designed to help you create horizontal lifeline solutions for your next project. It's intuitive design makes it easy to use and will provide you with a tailored project-specific system solution.









What you get?

- View your project details and see the system layout on your project drawings
- Creates a list of products and quantities needed for your project
- Ability to save and work on multiple projects
- Quickly amend and update current projects
- Download your full report easily and quickly
- Access technical performance details specific to your project
- Additional support, ready when you need it.

We have created this guide to ensure you get the most out of our Fall Protection Visualizer tool, however, should you need further support, please do not hesitate to get in contact with us.

Customer Support
E ukenquiries@sfs.biz
T +44 (0)330 0555 888
www.uk.sfs.com



 Account  500

Project Name: * <input type="text"/>	Roof Type * <input type="text"/>
Building Height (m): * <input type="text"/>	Roof Material * <input type="text" value="Select an Option"/>
Maximum Number of Users: * <input type="text"/> <small>Maximum number of user 4. This figure will be used to calculate the maximum load within 20%</small>	Insulation Depth <input type="radio"/> Tapered Insulation <input type="radio"/> Uniform Insulation
Roof/Membrane Manufacturer <input type="text"/>	Roof Substrate <input type="radio"/> Metal <input type="radio"/> Timber <input type="radio"/> Concrete
Roof Drawings * <small>Upload a PDF file.</small> <input type="button" value="Upload"/> <small>* Mandatory Field</small>	
Customer Notes <input type="text"/> <small><input type="checkbox"/> The service is supplied to you without charge and is based upon the relevance and accuracy of the information provided. We provide no warranties that the results of your use of the web-based tool is accurate and it is your responsibility to ensure that any calculations and/or results are independently verified by a suitably qualified person. By clicking "Next" the user accepts SFS Group's Terms and Conditions for Provision of Goods and/or Services Terms & Conditions</small>	<input type="button" value="Next"/>

1. Fill out the new project form and click "Next" to continue. The fields with "*" are necessary to continue to the next page. If any of the fields are unknown then a best guess should be applied and notes referencing this should be added to the "Customer Notes" section. Similarly, if the Number of Users is unknown then 4 users should be applied.

Roof Drawings

Acanth ▾

+ -

Re-center

Set Inset

Roof Identifier:

Add System

Calculate

Post Actions:

Clear Posts

Add Post

Plot Line

Post Module:

Highload ▾

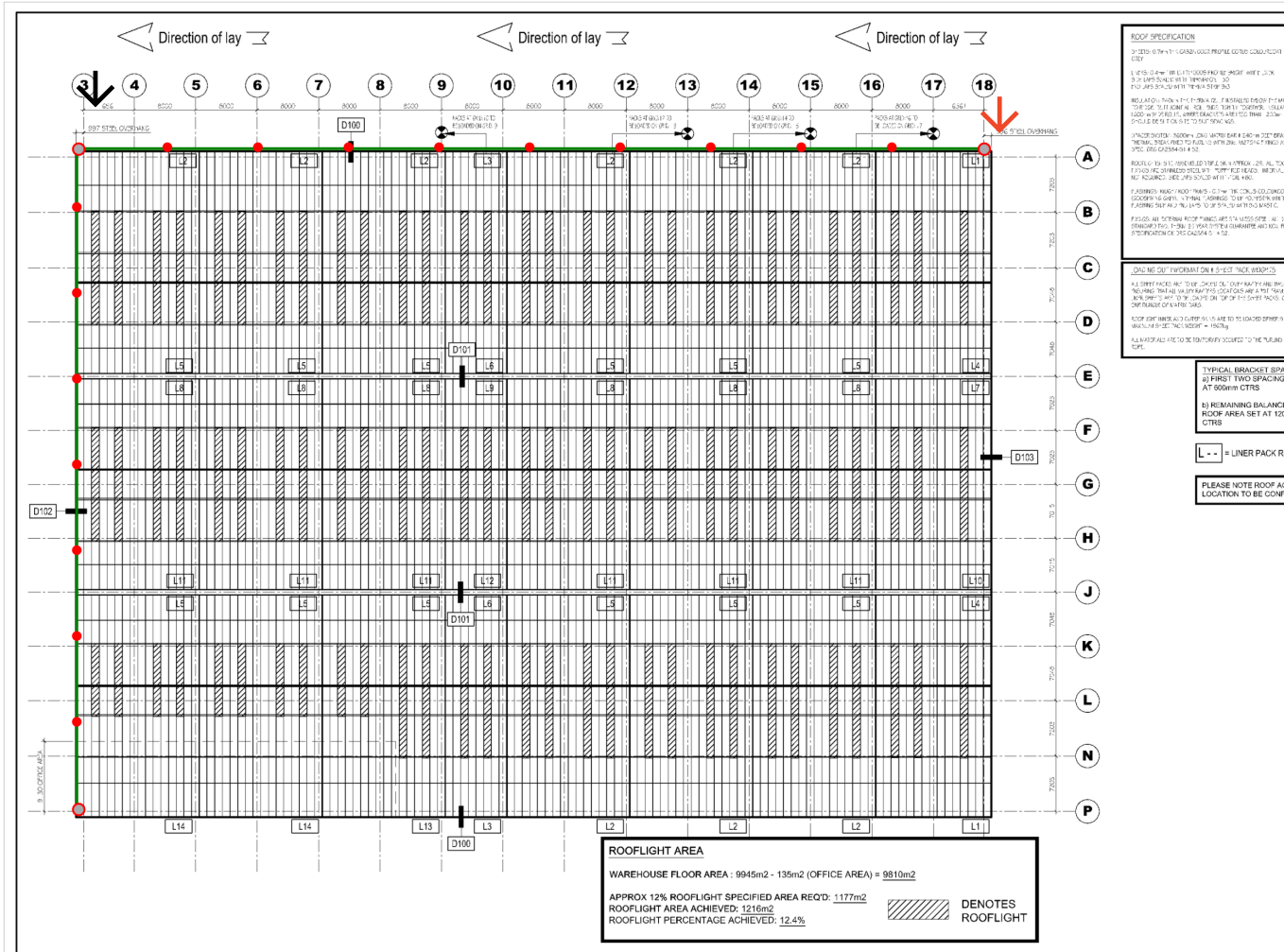

9. To join two lines of posts together, **double click** on a post (it should go green).
 Then **double click** on the post that you want to join the first post onto.

Roof Drawings

Acanth

+ -

Re-center

Set Inset

Roof Identifier:

Add System

Calculate

Post Actions:

Clear Posts

Add Post

Plot Line

Post Module:

Highload

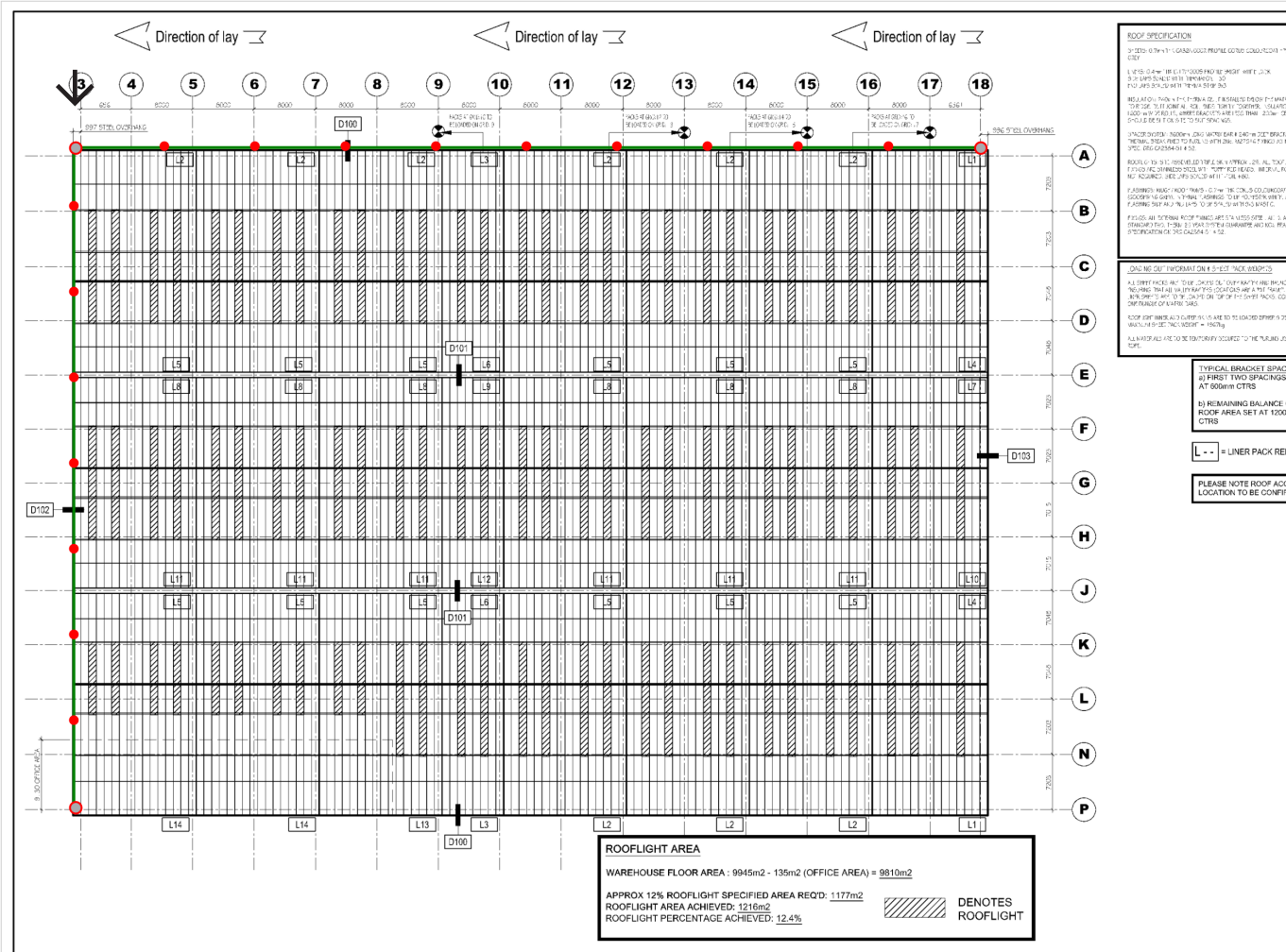

10. The posts will automatically be set to intermediate. To change a post's module, double click on the post and select the module from the "Post Module" dropdown.

Acanthus Park, Unit ▼

+ -

Re-center

Set Inset

System Identifier:

Add System

Add System Guide

Calculate

Post Actions:

Clear All Posts

Add Post

Plot Line

Post Module:

Intermediate ▼

Back

Next

11. To add a System Guide around the drawing, click on the "Add System Guide" button.

Acanthus Park, Unit ▼

+ -

Re-center

Set Inset

System Identifier:

Add System

Add System Guide

→ Calculate

Post Actions:

Clear All Posts

Add Post

Plot Line

Post Module:

▼

Back

Next

13. Click on the "Calculate" button and wait for the guide box to be resized based on the roof inset. This guide will be removed from the drawing when you click on the "Next" button and it will not appear in your pdf output.

Acanthus Park, Unit v

+ -

Re-center

Set Inset

System Identifier:

Add System

Add System Guide

Calculate

Post Actions:

Clear All Posts

Add Post

Plot Line

Post Module:

v

Back

Next

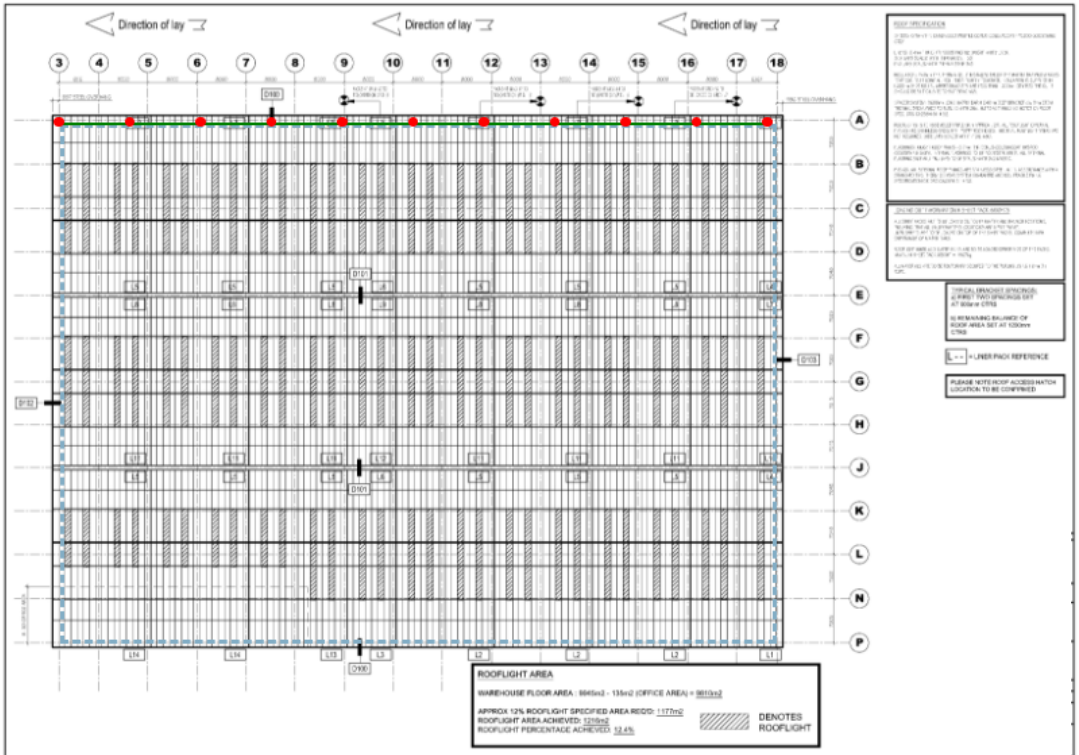

14. You can use the post action tools to plot a system over the guide lines, such as the "Plot Line" feature. Once you are happy with your drawing, click on the 'Next' button to retrieve your pdf.



Fall Protection Visualizer

Your project reference is: 1147

Please find attached your project specific report including component list and layout design.



↓ SFS Safety Line Solution for (SFS1147).pdf

Back

New Project



Get in touch

T: +44 (0)330 0555 888
E: ukenquiries@sfs.biz

[Home](#)
[Projects](#)
[Contact us](#)

15. Wait for the PDF to load and then click on the project next to the downward arrow to download your PDF, you will also receive an email with a link to download the PDF output. To start a new project, click on the "New Project" button. To go back and edit your drawing click on the "Back" button.

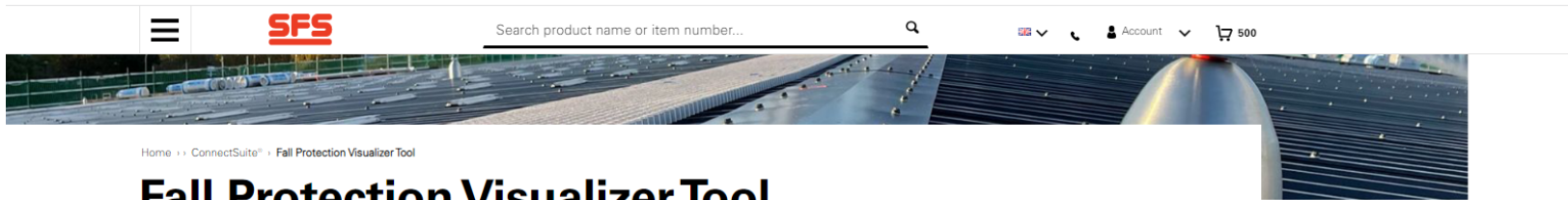

Home » ConnectSuite® » Fall Protection Visualizer Tool

Fall Protection Visualizer Tool

Welcome, we are the experts in Horizontal Lifeline solutions

Maximizing efficiency and precision is crucial when creating horizontal lifeline systems for your upcoming project. That's why we've developed the innovative **Fall Protection Visualizer tool** to streamline the process and provide you with accurate and reliable results. Its user-friendly interface makes it incredibly intuitive to use, providing you with a customised and project-specific solution that meets your unique requirements.

With this state-of-the-art tool, you can view your project details and system layout right on your project drawings, making planning a breeze. The tool generates a comprehensive list of products and quantities needed for your project.

For your convenience, we have prepared a comprehensive PDF guide to help you maximise the potential of this tool, which can be downloaded below.

When you need additional support, our team of experts is always available to assist you. Experience the future of project planning with the Fall Protection Visualizer tool and see how it can optimize your project's success. Please don't hesitate to [contact us](#).

— Get Started



New Project →



My Projects →

16. You are able to edit your projects from the Fall Protection Visualizer home page by selecting 'My Projects'.



Search product name or item number...

0 product(s)

- [Products](#)
- [Systems](#)
- [Knowledge Hub](#)
- [Services](#)
- [About SFS](#)
- [ConnectSuite®](#)
- [File Upload](#)

Home >> ConnectSuite® > Fall Protection Visualizer Tool

	Name	Version	Last Updated	Search
<input type="checkbox"/>	Test Project (SFS1166)	1	2021-09-14 08:30:36	
<input type="checkbox"/>	Test Project (SFS1174)	3	2021-09-30 13:28:33	

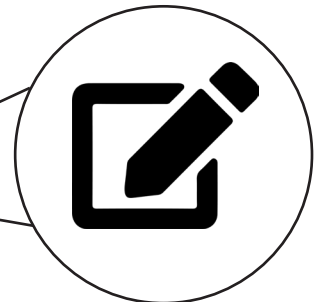

17. After selecting 'My Projects' you will be taken to the list of all completed projects, press the 'Edit' icon against the project you wish to amend. Please then repeat Step's 1-10.

☰

🇬🇧
📞
👤 Account
🛒 500

New Project

Project Name: *

Roof Type *

Flat
▼

Building Height (m): *

Roof Material *

Bituminous
▼

Maximum Number of Users: *

Maximum number of user 4. This figure will be used to calculate the maximum load within 20%

Insulation Depth

Tapered Insulation Uniform Insulation

Roof/Membrane Manufacturer

Roof Substrate

Metal
 Timber
 Concrete

Roof Drawings *

Upload a PDF file.

Upload

FPV PDF.pdf

* Mandatory Field

Customer Notes

➔

Next

18. If you choose to edit your Project information, you will be taken back to the 'New Project' form. The current project information will be loaded into the form. If you are happy with the project information and just wish to edit the drawings, press "Next". If you edit the Maximum Number of Users, the Building Height or the uploaded drawing then any previous schemes will be cleared and have to be re-done in the next stage.



SFS Group Fastening Technology Ltd.
Division Construction
153 Kirkstall Road
Leeds, LS4 2AT
ukenquiries@sfs.com
www.uk.sfs.com

All information is non-binding and without guarantee. Before using the products, all specifications and calculations must be checked by a suitably qualified person and local regulations must be observed. This document is subject to revision. We reserve the right to make technical changes.
V2 03/2023