

SFS intec Easy 3D program

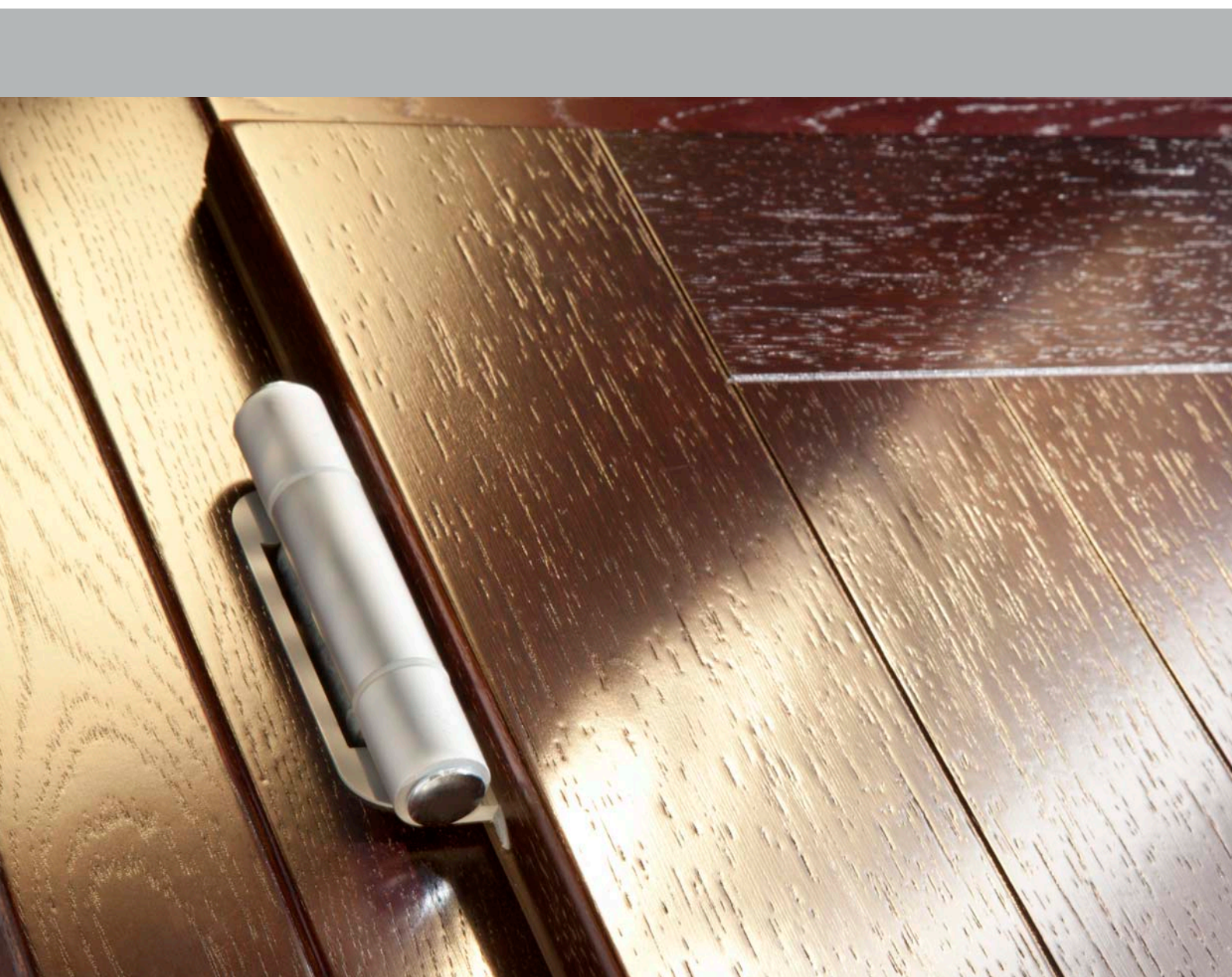

Over the years the constant attention to new market trends and SFS intec's focus on the final user have led our business to develop an extensive range of hinges for entrance doors: the Easy 3D program.

Created to meet the need expressed by our customers for hinges for heavy doors that are easy to install and to adjust, today the Easy 3D range is able to cover most applications in various markets and namely five different profiles each with its own hinge.

New energy-saving trends and increasingly heavier doors, call for top performing certified hinges. Our Easy 3D hinge was awarded CE certification by the IFT Institute in Rosenheim, who also certified it to be suitable for use on fire doors. Plus, it can support loads up to 160 Kg, which makes it the optimal solution for all kinds of needs.

Its extremely high resistance to corrosion, the security screw fitted to each hinge and the wide range of finishes available give the door a unique top quality appearance.

The system, which comes with milling jigs and inserts, allows easy application of the hinges to most profile types.



Why choose a milling hinge

- greater load-bearing capacity, up to 160 Kg
- greater door stability
- a hinge that always maintains its vertical axis
- greater aesthetic value of the door

Why choose Easy 3D

- 8 different colours - no need to add additional cover caps
- 7 versions for 20 types of profiles
- security screws as standard on all versions
- extremely high resistance to corrosion thanks to the materials used
- each hinge can be adjusted in 3 dimensions to better distribute weight
- it can also be used with two hinges only whilst still maintaining the three adjustment levels
- easy to adjust when the door is closed
- only two holes in the frame for better looks when the door is open
- suitable for use on fire doors

Hinges with an eye to the future

The hinges of a door are like the engine of a car and for the last 50 years SFS intec has not been offering compromises, but solutions with an eye to the future. Solutions that are always fully compliant with European regulations and, above all, solutions that do not require maintenance over time.

Easy 3D-00

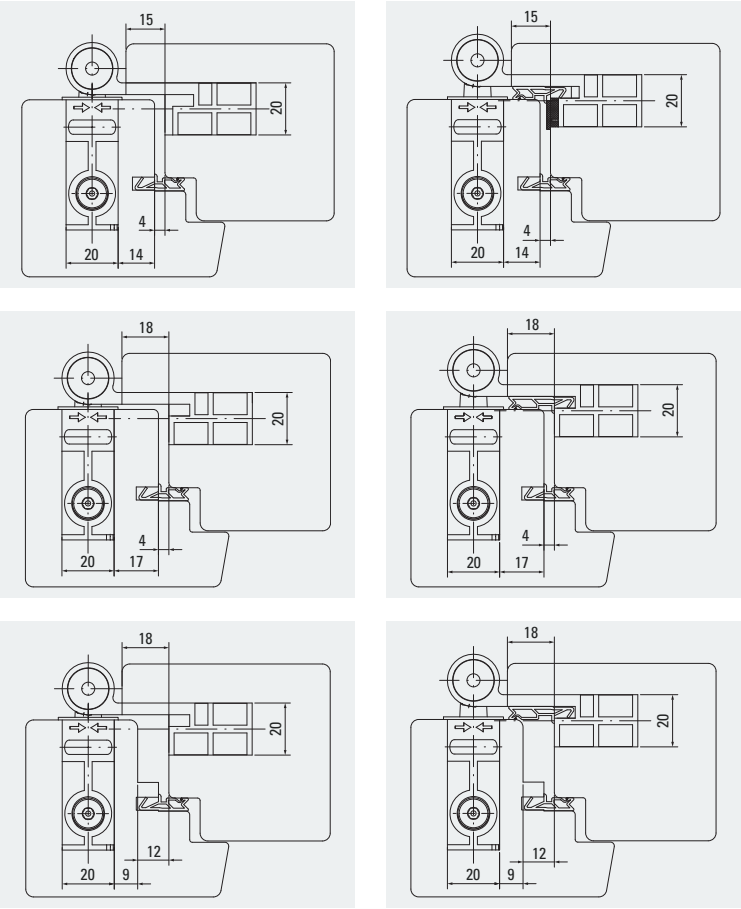

Code	Finishing	Packaging
994528	white RAL 9016	3 pcs.
994529	brown RAL 8017	3 pcs.
113597	black RAL 9005	3 pcs.
994533	brassed	3 pcs.
994531	matt chromed	3 pcs.
994534	matt nickel	3 pcs.
713771	light bronzed	3 pcs.
1105357	powder coated light inox	3 pcs.
1280019	imitation matt inox	3 pcs.

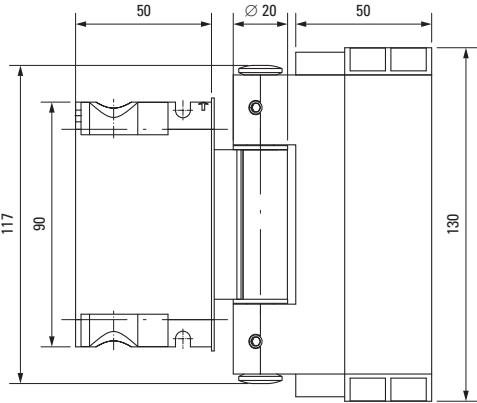

Easy 3D-09

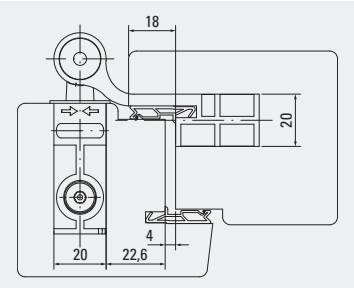

Code	Finishing	Packaging
1175275	white RAL 9016	3 pcs.
1175279	brown RAL 8017	3 pcs.
1246882	black RAL 9005	3 pcs.
1175276	brassed	3 pcs.
1272744	matt chromed	3 pcs.
1175278	matt nickel	3 pcs.
1175277	light bronzed	3 pcs.
1175280	powder coated light inox	3 pcs.
1338345	imitation matt inox	3 pcs.

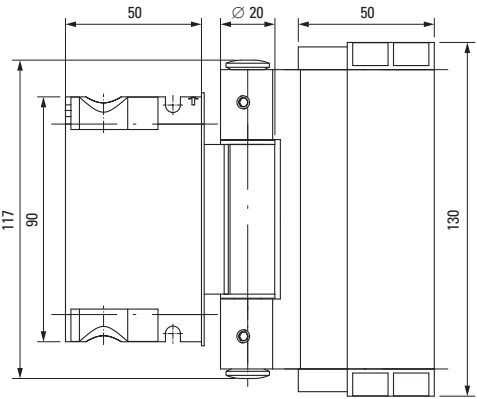

Easy 3D-08

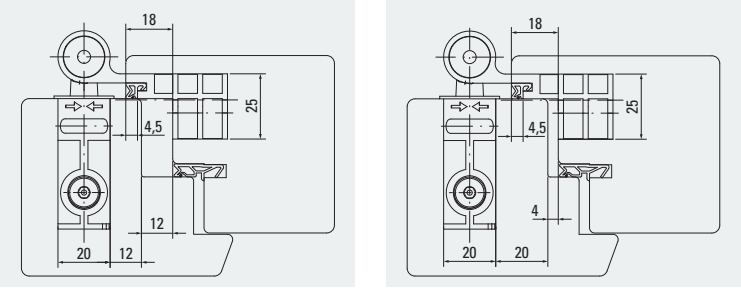

Code	Finishing	Packaging
1214108	white RAL 9016	3 pcs.
1179502	brown RAL 8017	3 pcs.
1272865	black RAL 9005	3 pcs.
1179489	brassed	3 pcs.
1272723	matt chromed	3 pcs.
1190141	matt nickel	3 pcs.
1177840	light bronzed	3 pcs.
1249880	powder coated light inox	3 pcs.
1246880	imitation matt inox	3 pcs.

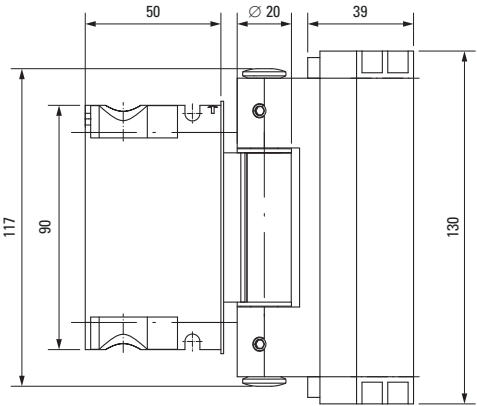

Easy 3D-10

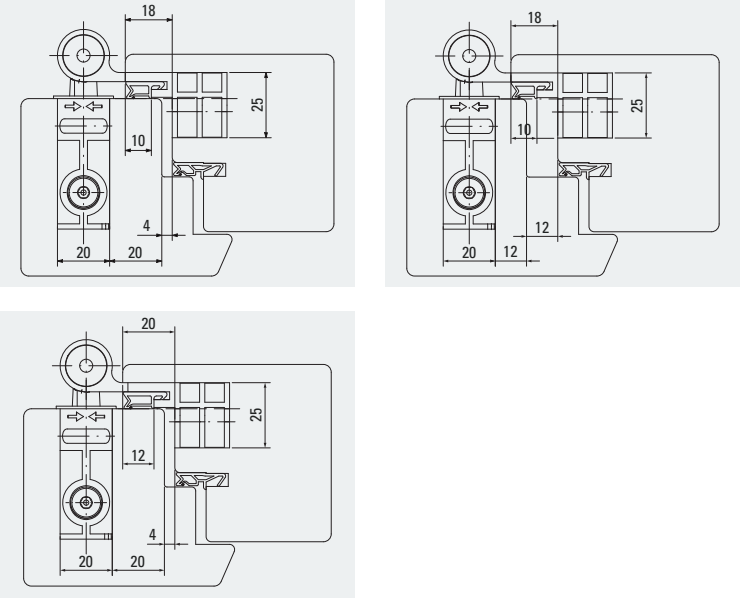

Code	Finishing	Packaging
1208865	white RAL 9016	3 pcs.
1208863	brown RAL 8017	3 pcs.
1246883	black RAL 9005	3 pcs.
1239710	brassed	3 pcs.
1272818	matt chromed	3 pcs.
1235007	matt nickel	3 pcs.
1208861	light bronzed	3 pcs.
1241284	powder coated light inox	3 pcs.
1280027	imitation matt inox	3 pcs.

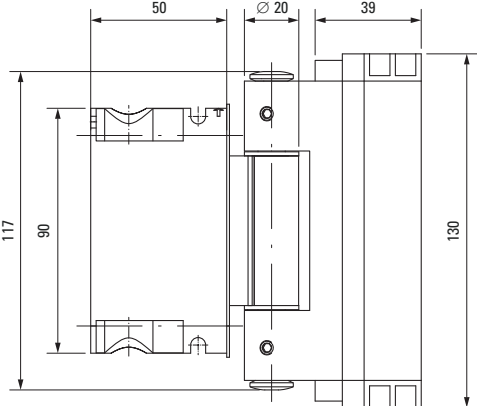

Easy 3D-11

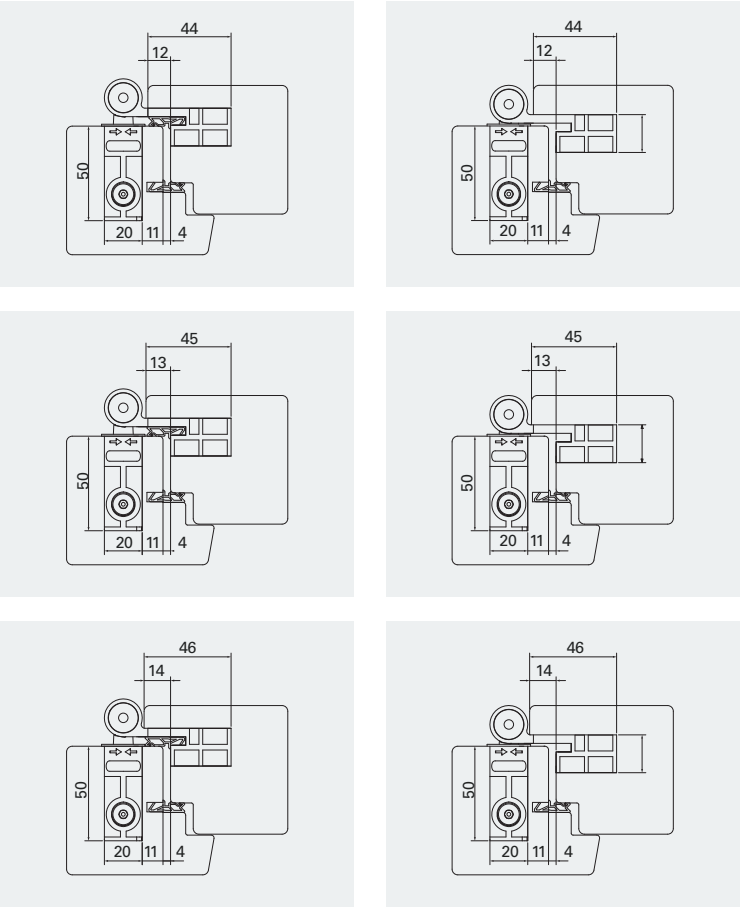

Code	Finishing	Packaging
1338353	white RAL 9016	3 pcs.
1338355	brown RAL 8017	3 pcs.
1338381	black RAL 9005	3 pcs.
1338382	brassed	3 pcs.
1338383	matt chromed	3 pcs.
1338389	matt nickel	3 pcs.
1338390	light bronzed	3 pcs.
1338391	powder coated light inox	3 pcs.
1338393	imitation matt inox	3 pcs.

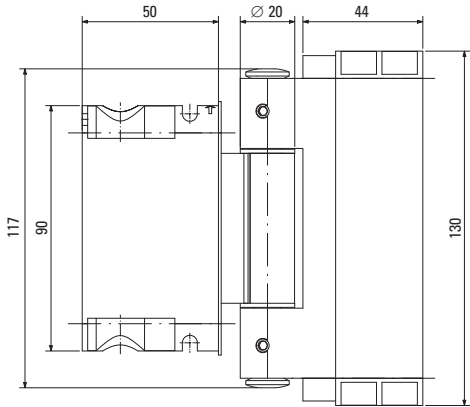

Easy 3D-12

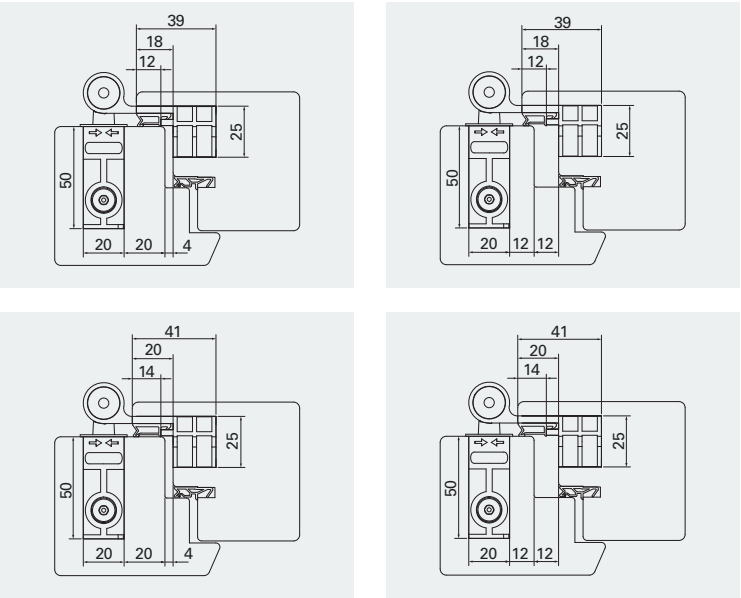

Code	Finishing	Packaging
1332719	white RAL 9016	3 pcs.
1332721	brown RAL 8017	3 pcs.
1338395	black RAL 9005	3 pcs.
1332724	brassed	3 pcs.
1316907	matt chromed	3 pcs.
1338396	matt nickel	3 pcs.
1332723	light bronzed	3 pcs.
1338397	powder coated light inox	3 pcs.
1332731	imitation matt inox	3 pcs.

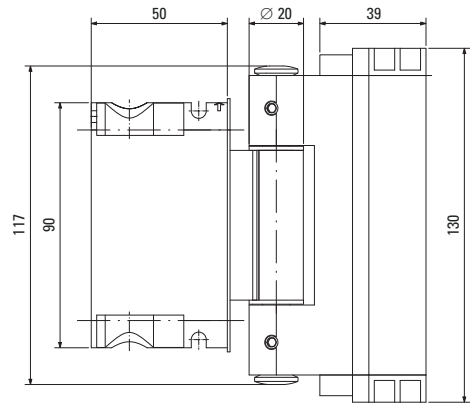

Easy 3D-01 Ø 15

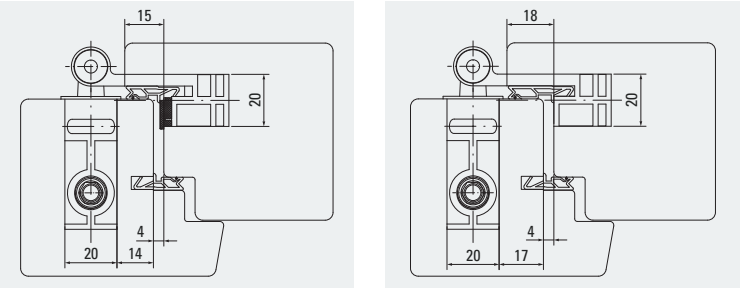

Code	Finishing	Packaging
1246949	white RAL 9016	3 pcs.
1179936	brown RAL 8017	3 pcs.
1246962	black RAL 9005	3 pcs.
1179932	brassed	3 pcs.
1272759	matt chromed	3 pcs.
1246950	matt nickel	3 pcs.
1179935	light bronzed	3 pcs.
1246961	powder coated light inox	3 pcs.
1338346	imitation matt inox	3 pcs.

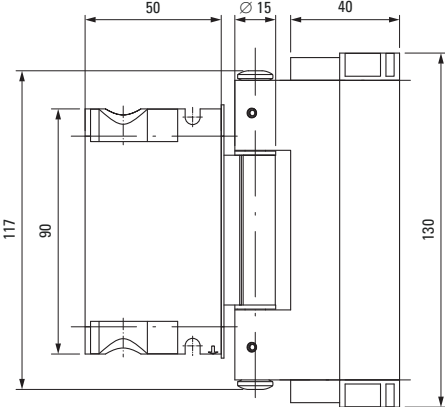

Device for Easy 3D-00 hinge

The device, which is available with our Easy 3D-00 hinge, allows to easily and quickly adapt the hinge to the shape of the profile, going from a 18mm gasket to a 10/12mm gasket.

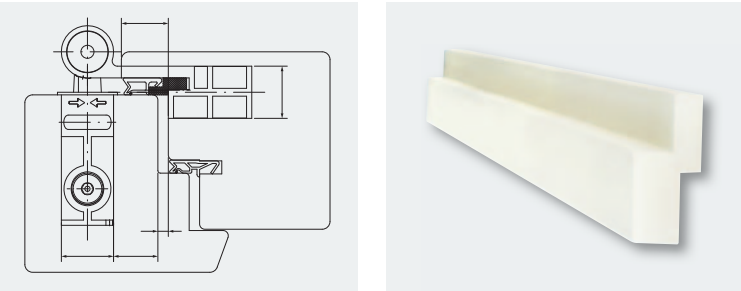

Code	Finishing	Packaging
1272299	Natural nylon	1 piece

Milling covering cap for 15 mm frame

A milling covering cap is available for applications on 15mm frames. The same cap can be used for applications with or without frame gasket and is available in various colours.

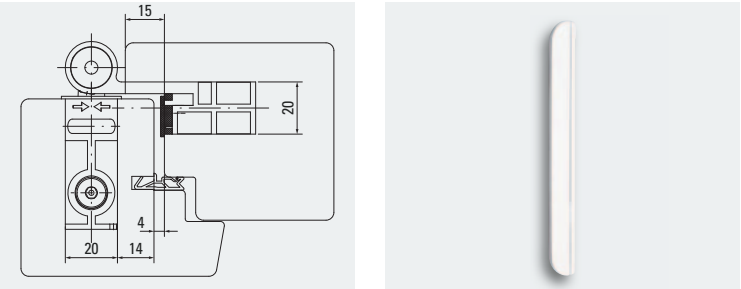

Code	Finishing	Packaging
710858	white RAL 9016	12 pcs.
710859	brown RAL 8017	12 pcs.
710860	brassed	12 pcs.
711229	matt chromed	12 pcs.
710861	matt nickel	12 pcs.

Easy 3D-20 inox

The Easy 3D inox hinge has been designed to meet the needs of those who want a modern and contemporary look such as satin polished stainless steel. Easy to assemble and adjust, the typical features of this hinge are combined with the modern touch of satin polished stainless steel.

The use of special 3-step bolts, a patent developed by SFS intec, ensures extraction resistance levels of over 1500 Kg, which guarantees steady fixing of the hinge on any type of profile.

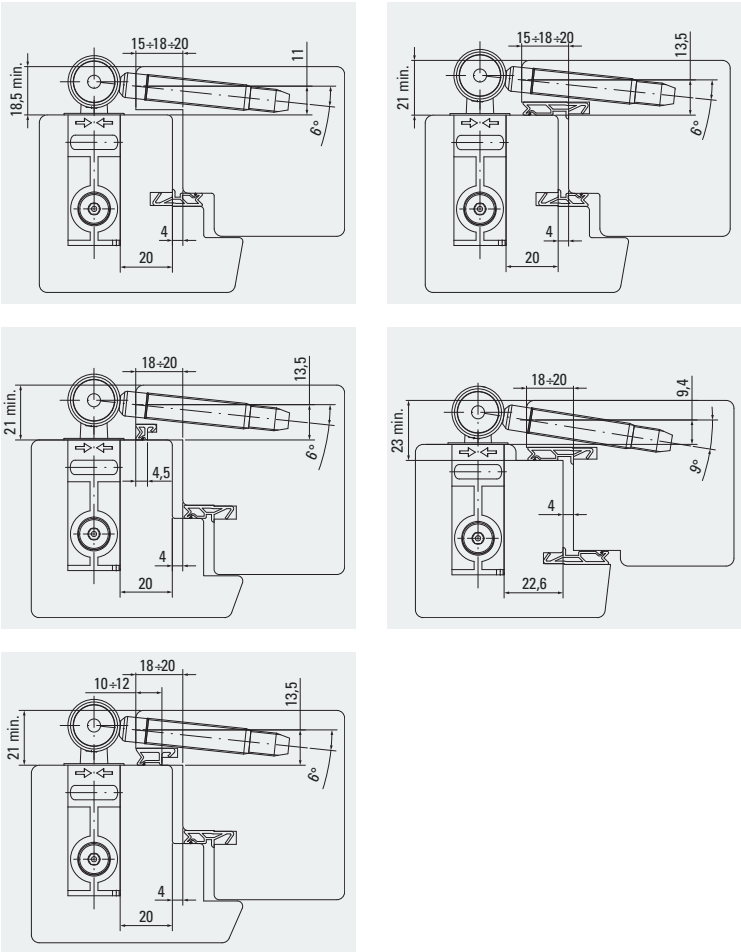

Code	Finishing	Packaging
1272868	satin polished stainless steel	3 pcs.

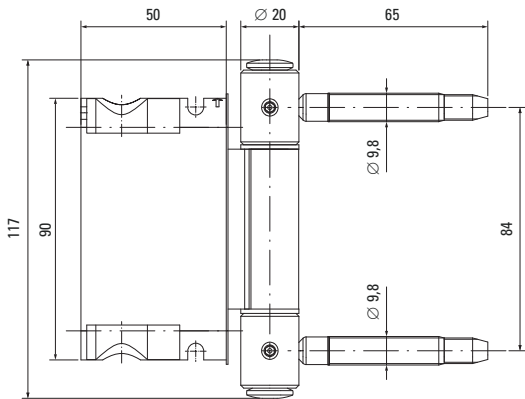

The 3-step threaded bolts and the use of a 2-step drill bit allow fast and problem-free fitting of the hinge.

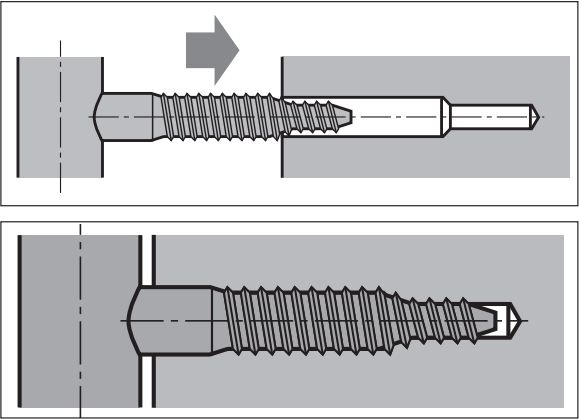

Once you have made the hole with the 2-step drill bit, step 1 of the threaded bolt can be easily inserted in the hole and automatically centres the hinge.

Once inserted, the hole adapts perfectly to the threaded bolt and ensures the latter is anchored securely in the wood along its entire length. Moreover, the rear section of the threaded bolt compresses the wood, which increases the hinge's stability.

Adjusting the hinges

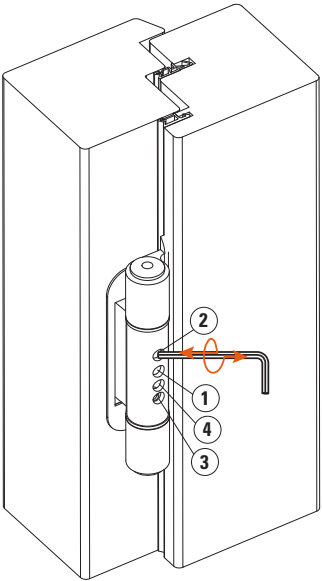

Horizontal	+/- 3 mm
Height	+ 3 mm / - 2 mm
Gasket pressure	+/- 2 mm

The adjustment holes are placed on the front of the hinge. These are independent, mechanical adjustments which do not interfere with each other and are made with a 4 mm hex key. Each hinge can be adjusted in 3 dimensions to better distribute the weight on all the hinges. Therefore then can be adjusted in any order.

Horizontal adjustment

1. Loosen the screw in hole 1.
2. Adjust the hinge with the 4 mm hex key by acting on screw 2.
3. After completing the desired adjustment, screw back screw 1.

Height adjustment

1. Carry out the height adjustment by operating on screw 3.
2. To distribute weight properly, carry out the adjustment first on one hinge and then gently line up the adjustment screws of the other hinges.
3. The adjustment is a self-locking mechanism.

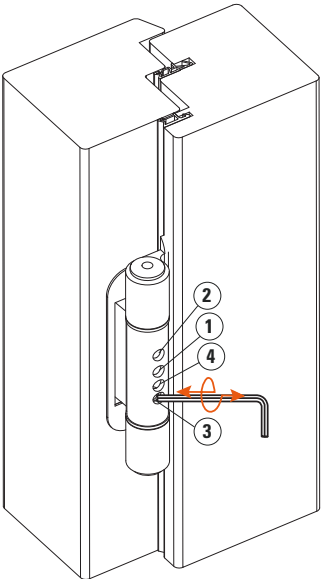

Gasket pressure adjustment

1. Carry out the gasket pressure adjustment by operating on screw 4.
2. The adjustment is a self-locking mechanism

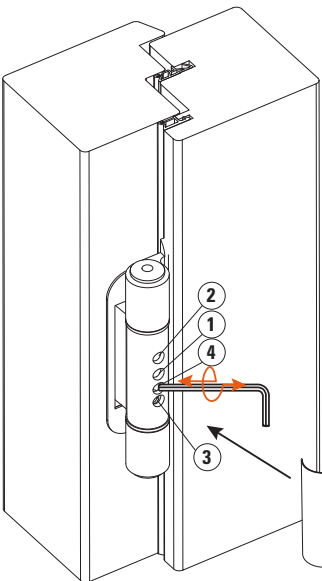

Once the adjustments are completed, fit the cap in the main body.

Certified hinge in accordance with EN 1935:2004 standard



Each hinge can be adjusted in 3 dimensions to better distribute weight

Several profiles and gaskets

Only two holes on the frame



Safety dowel as a standard on all versions

Each hinge is checked and centred before dispatch

Wear-resistant self-lubricating bushes

Available in nine different colours

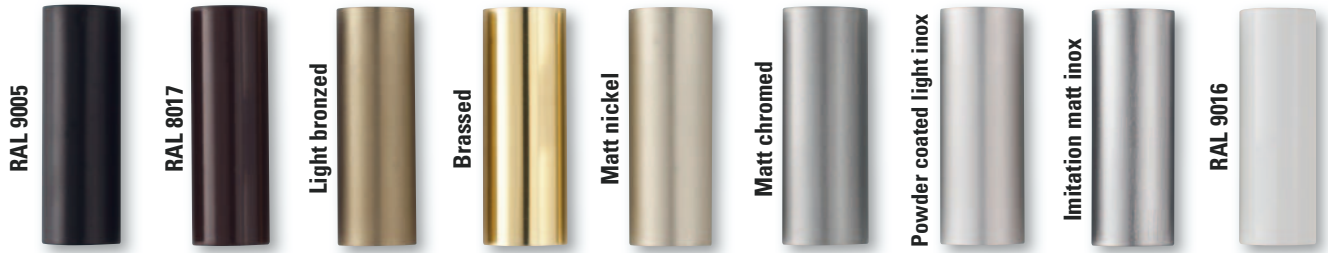

Milling jig for sash



The milling jig can be used to carry out milling on the hinges listed below:

- E3D 00
- E3D 08
- E3D 09
- E3D 10
- E3D 11
- E3D 12

It is supplied without the bakelite device, which has to be ordered separately

Code	
1338998	Milling jig

Bakelite devices for the different versions

Code	
1272544	Device Easy 3D-00
	Device Easy 3D-09
	Device Easy 3D-11
	Device Easy 3D Ø15
1272742	Device Easy 3D-08
	Device Easy 3D-10
	Device Easy 3D-12

Drilling jig for Easy 3D inox sash



Code	
1272876	Jig

Sash milling diagrams

Easy 3D-00

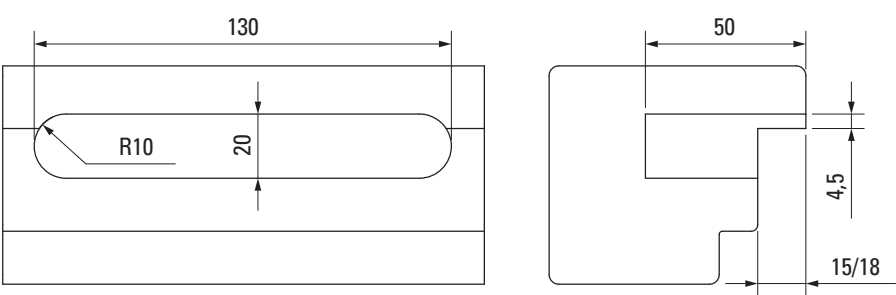

Easy 3D-08-10-12

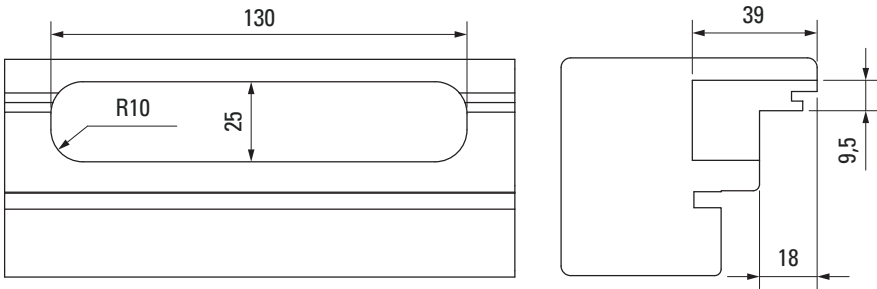

Easy 3D-09

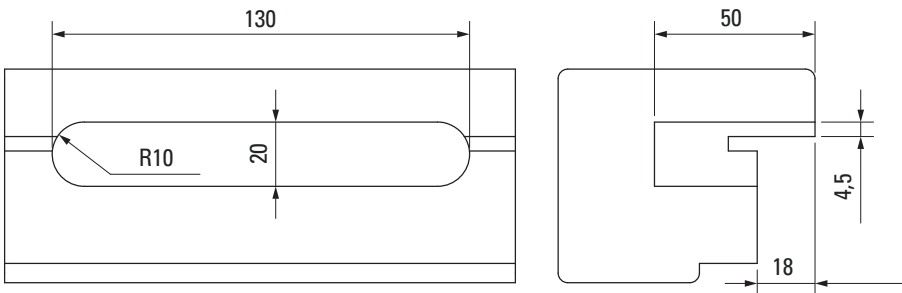

Easy 3D-11

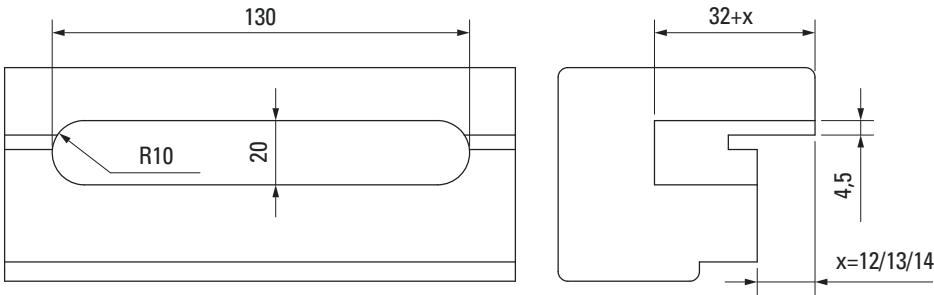

Easy 3D-01 Ø 15

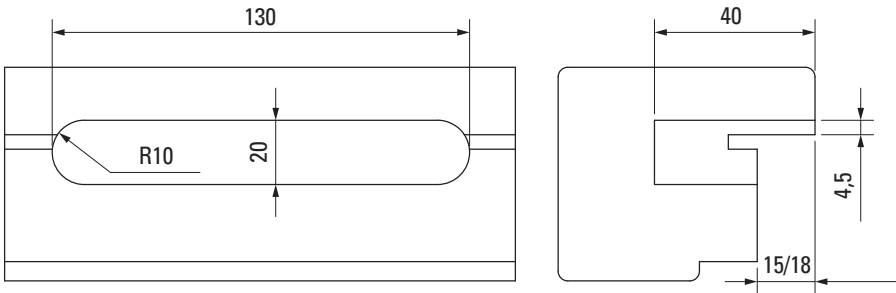

Frame milling jig



The milling jig can be used on all Easy 3D hinge models.
It is supplied without the bakelite device, which has to be ordered separately

Code	
1339001	Milling jig + drilling block

Bakelite devices for the different versions

Code	
1272545	Device Easy 3D-00 Device Easy 3D-11 to be used with spacer cod. 1331308 Device Easy 3D Ø15
1272743	Device Easy 3D-08 Device Easy 3D-10 Device Easy 3D-12
1272752	Device Easy 3D-09

Code	
1331308	Spacer for Easy 3D-11
1272246	Spacer for Easy 3D with air gap 12 mm

Reference jig for frame drilling



For customers who employ machines with a numerical control to carry out milling, there is a reference jig that allows to make the hinge's locking holes manually on the machine.

Code	
1272674	

Frame milling diagrams

E3D-00 and E3D Ø 15
overlap 15mm with air gap 4 mm

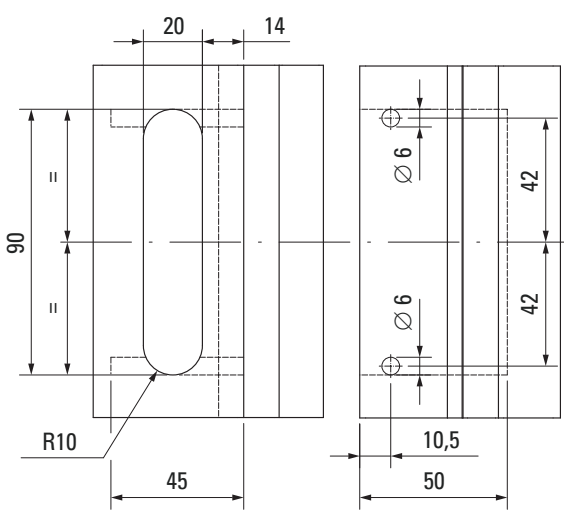

E3D-00 e E3D Ø 15
overlap 18mm with air gap 4 mm

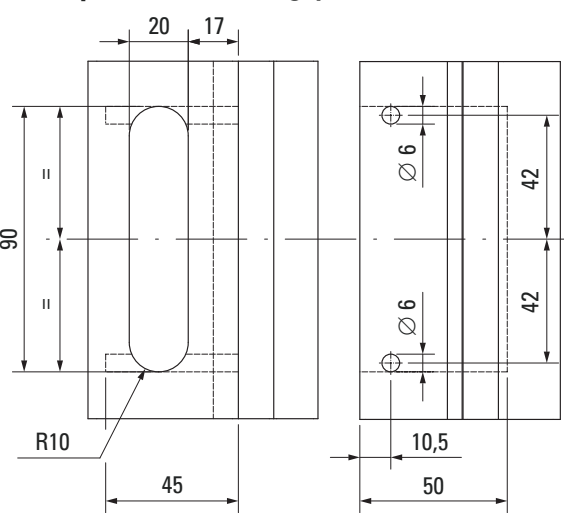

Easy 3D-08-10-12
overlap 18-20mm with air gap 4 mm

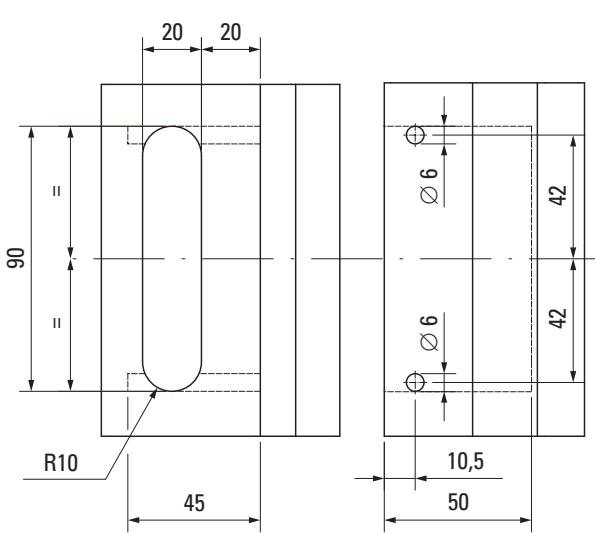

Easy 3D-09
overlap 18mm with air gap 4 mm

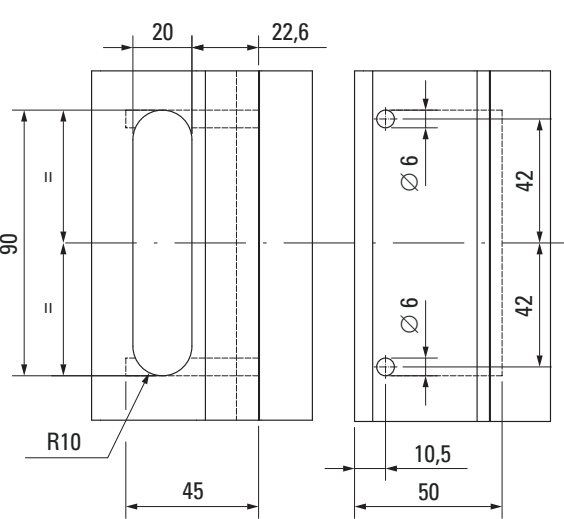

Easy 3D-11
overlap 12-13-14mm with air gap 4 mm

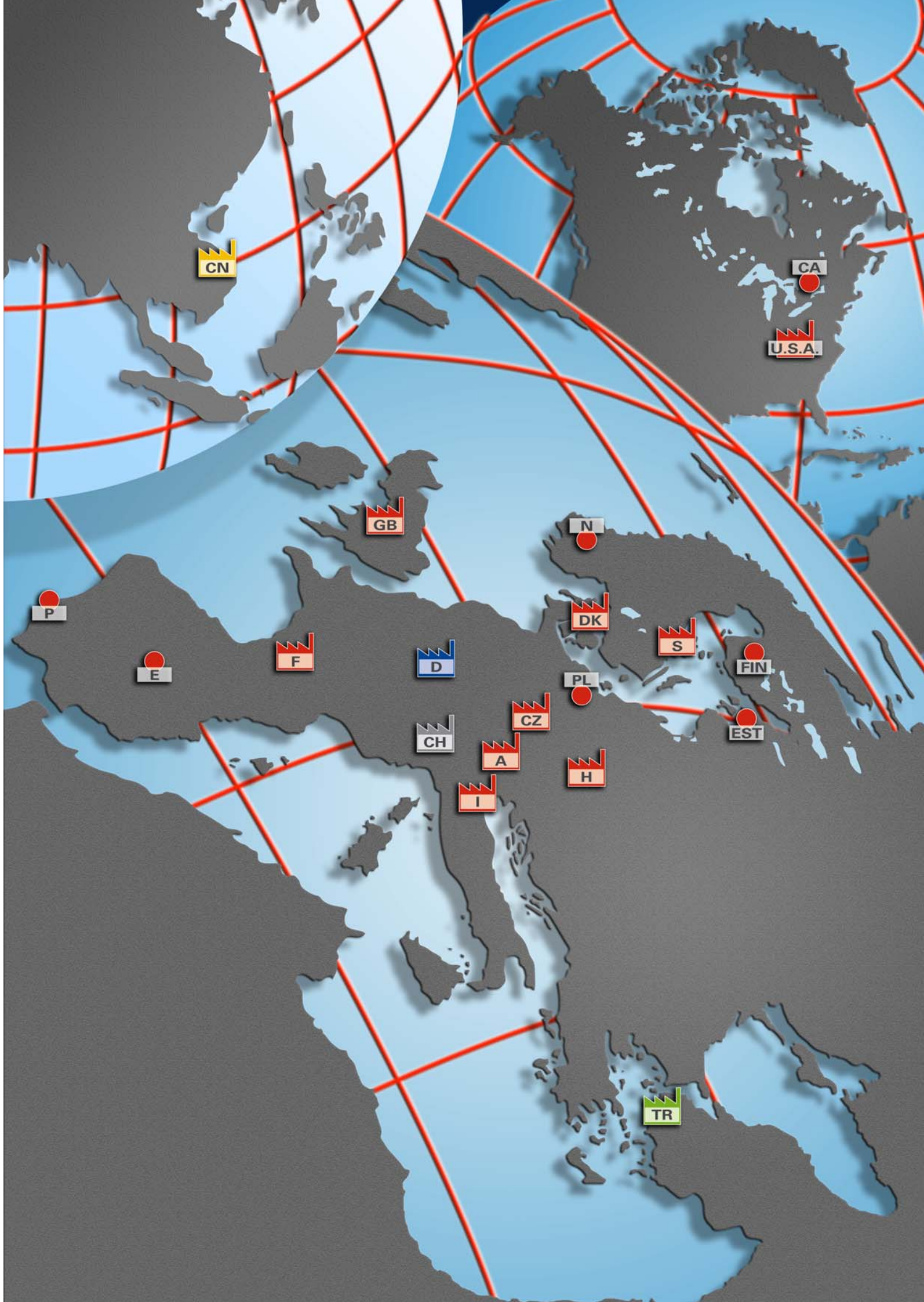
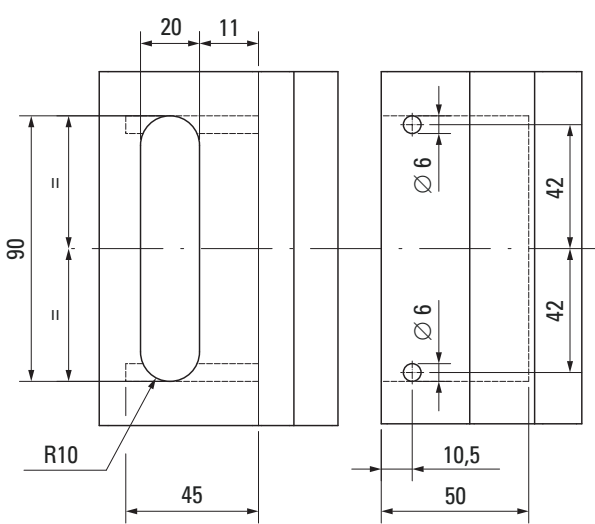

SFS intec s.p.a.

Via Castelfranco Veneto, 71
IT-33170 Pordenone

Tel. 0434 99 51
Fax 0434 995201
it.pordenone@sfsintec.biz
www.sfsintec.biz/it

SFS intec
Turn ideas into reality